

### Solid Copper Earth Rods

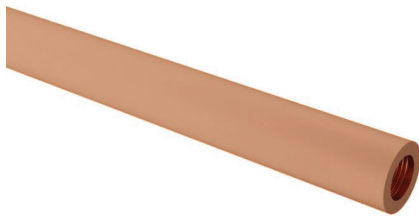

Used where soil conditions are aggressive, ie high salt content.

**Solid Copper Earth Rods** have a tapped hole at each end which allows them to be joined together by means of a coupling dowel.

LENGTH (mm)	DIAMETER (mm)	INTERNAL THREAD (mm)	WEIGHT (kg)	PART No.
1200	15	M10	1.85	ERSC1504
1200	16	M10	2.10	ERSC1604
1500	16	M10	2.49	ERSC1605
1800	16	M10	2.99	ERSC1606
2400	16	M10	3.99	ERSC1608
3000	16	M10	4.99	ERSC1610
1200	20	M10	3.30	ERSC2004
1500	20	M10	4.14	ERSC2005
1800	20	M10	5.02	ERSC2006
2400	20	M10	6.70	ERSC2008
3000	20	M10	8.38	ERSC2010
1200	25	M10	5.18	ERSC2504
1500	25	M10	6.48	ERSC2505
1800	25	M10	7.78	ERSC2506
2400	25	M10	10.37	ERSC2508
3000	25	M10	12.97	ERSC2510

**Material:** 99.9% Hard Drawn Copper

**Standard:** BS:EN 62561-2, BS 7430

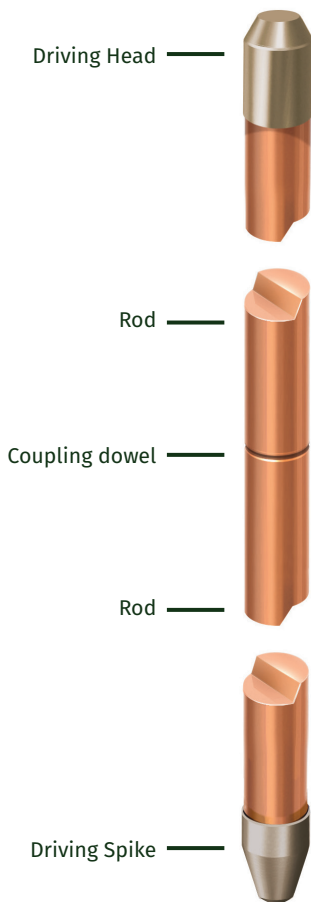

#### APPLICATION

